

Technical Installation Instructions



Parts required to mount cistern to pan



Attach cistern bolts into pan
Tighten bolts from underneath



Ensure outlet rubber is fitted to cistern



Sit cistern onto pan.

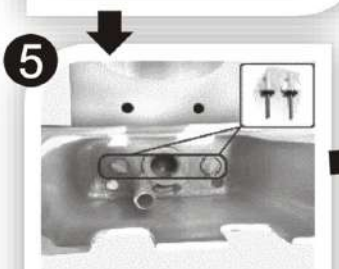

Use supplied bolts to fasten cistern to pan

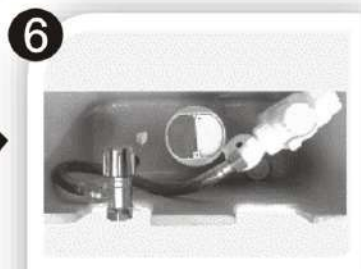

Top inlet finish

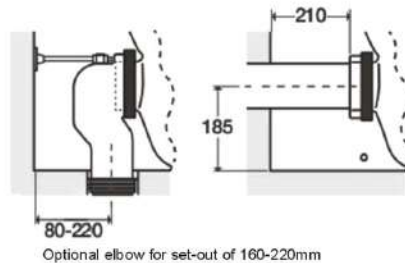
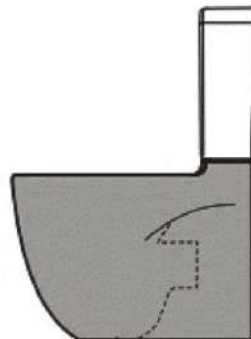

Adjustable S Trap Pan Connector Offset (optional)

1. Open the box and check all the components.
2. Insert the expansion fittings (5) into the seat bolt holes in the WC.
3. Assemble washers (4), Hinge fixings (3) and the bolts (2) as shown in the diagram. Leave loosely attached.
4. Align the hinge housing of the seat with the hinge fixings and adjust the seat to desired position.
5. Remove the seat by depressing the chrome release buttons and lifting upwards.
6. Tighten the bolts with a Phillips head screwdriver ensuring that the expansion fittings are secure. Put the decorative cap in the position, then place the seat on the hinges.

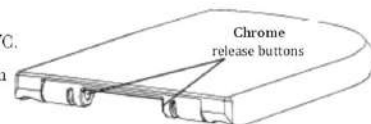

- ① Decorative cap
- ② Bolt
- ③ Hinge fixing
- ④ Washer
- ⑤ Expansion fitting



SUS hinge, rotate 360° suit kind of toilet.



You only need to Press The 2 Buttons



Available with inserted hinge For Easy Installation.



Easy Lift